

## SUGGESTED ON-SITE CONSTRUCTED SHOWER BASE DETAIL FOR SINGLE FAMILY DWELLING UNITS

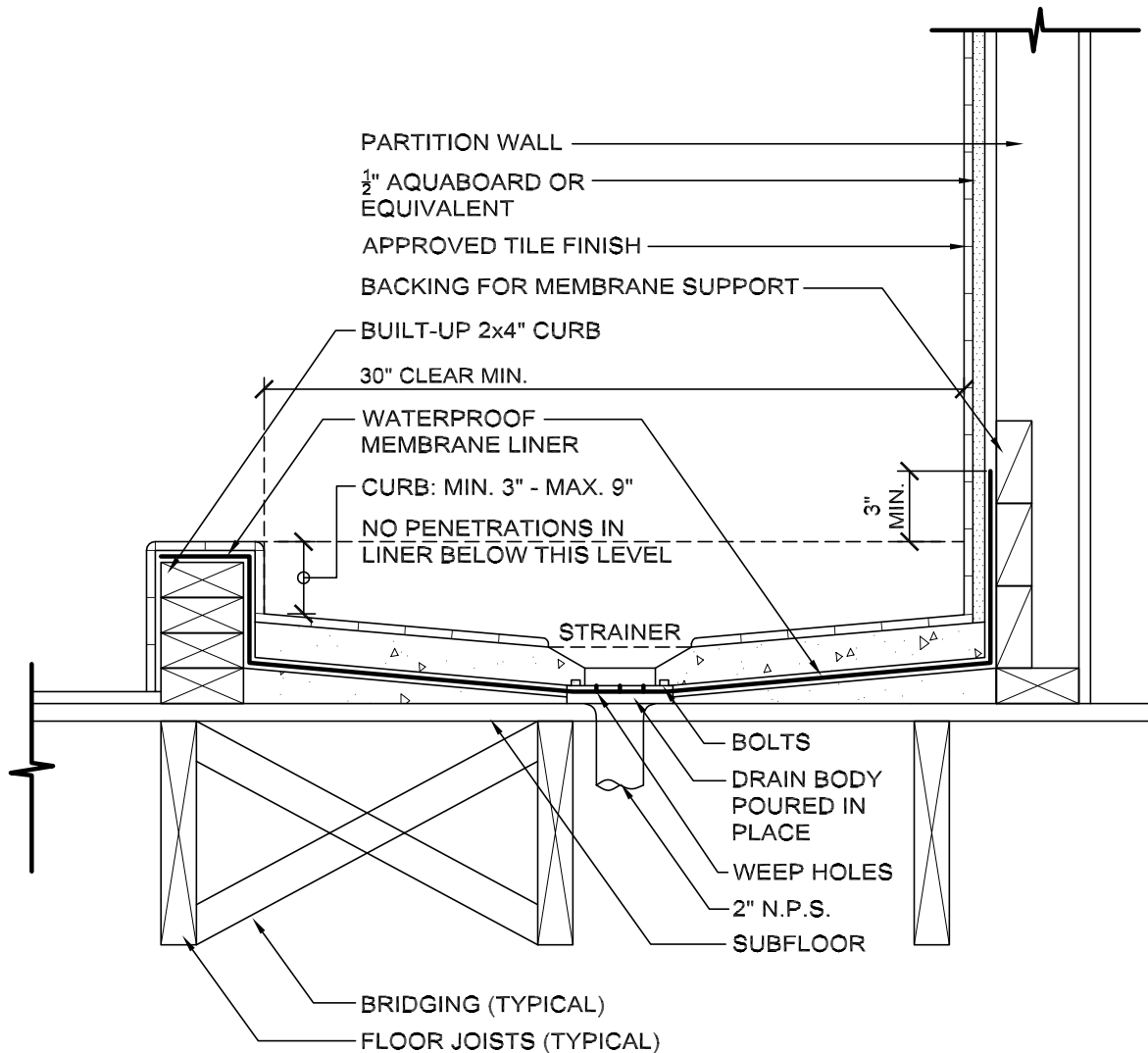

**GENERAL NOTES:**

- BACKING TO BE INSTALLED BETWEEN STUDS TO SUPPORT LINER.
- WEEP HOLES MUST BE PROTECTED FROM BLOCKAGE.
- LINER SHALL BE WATER TESTED TO THE FLOOD LEVEL RIM.
- THE MIN. USABLE AREA SHALL BE 900 SQ.IN. WITH NO DIMENSION LESS THAN 30".
- NO MATERIAL THAT MAY BE HARMED BY MOISTURE SHALL BE USED INSIDE THE LINER.
- SHOWER DOOR SHALL NOT OPEN INSIDE THE SHOWER STALL.